



Fitting Instructions

TOWBAR
For Mercedes Sprinter
With Tail Lift

MATERIALS

A	1	Cross Bar with European facing to 94/20/EC A50-1
D	8	M12 x 110mm Bolts, Nyloc Nuts and 16 Ø40 Flat Washers
CB	2	M16 x 50mm Coupling Bolts, Nuts and Lock Washers
ZE	1	Electrical Plate (Not shown) ZEP35

Note: A fuel tank shield may be required – refer to vehicle handbook.

FITTING

1. Remove towing eye from right hand chassis rail, loosely attach Cross bar (**A**) to existing bushed holes in vehicle chassis using Bolts (**D**) with Flat Washers fitted as shown below.
2. Fully tighten bolts to torques listed below

Note: This towbar must be used with a Class A50-1 or A50-X towball dimensionally conforming to A50-1 with a 'D' and 'S' value greater than or equal to that of the towbar.

Please refer to the vehicle specification for the trailer weight and nose limits, which **must be observed**.

Recommended torque settings:

Grade 8.8 bolts: M12 – 80Nm, M16 - 214 Nm

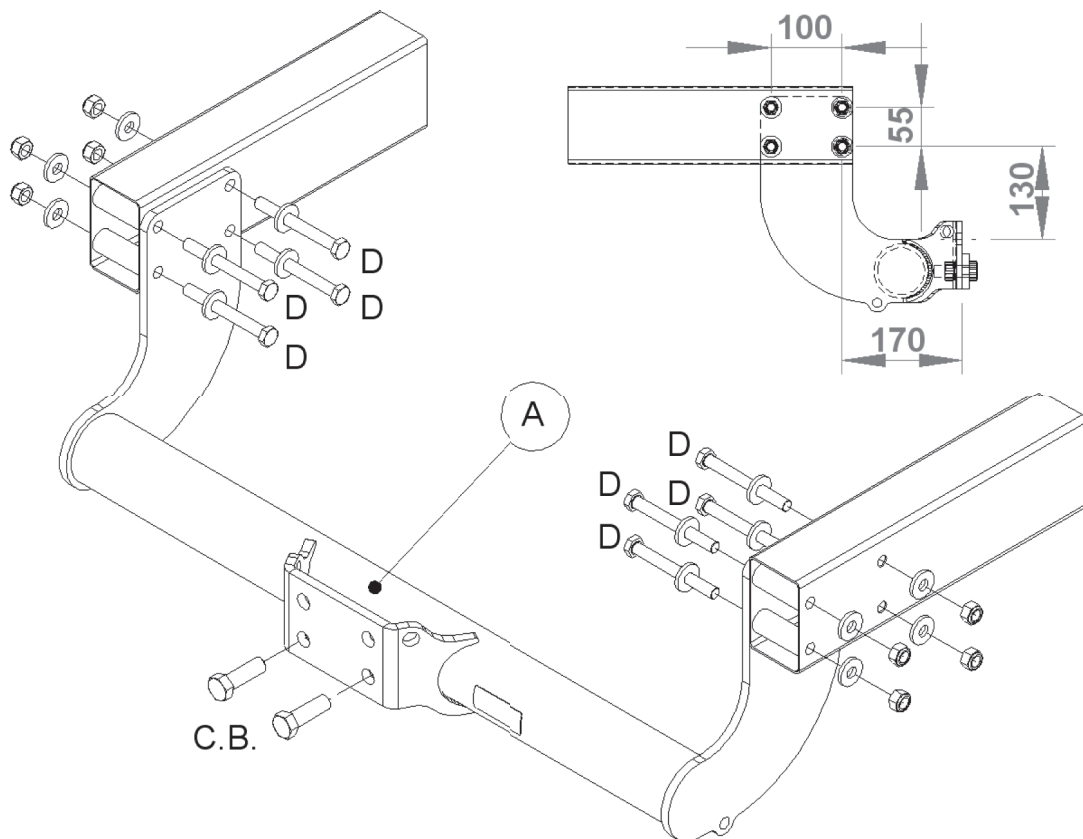

W0001MR45A-FIT\$010807100000